

**ITEM 14. MOBILE CRANES – TEMPORARY ROAD CLOSURES – SEYMOUR
PLACE PADDINGTON**

TRIM RECORD NO: 2017/541509

RECOMMENDATION

It is recommended that the Committee endorse the temporary road closure of Seymour Place, between South Dowling and Selwyn Streets, Paddington, on 25 January, 22 February, 22 March, 19 April, 17 May, 14 June, 12 July, 9 August, 6 September, 4 October, 1 November, 29 November and 27 December 2018, from 10am to 1pm subject to the following conditions:

- (A) The Applicant must comply with the temporary road closure conditions as mentioned in Schedule C of this Agenda.
- (B) The Applicant must comply with any other conditions imposed by City's Construction Regulation Unit.
- (C) The Applicant must contact Surry Hills Police to obtain a separate police permit and to discuss deployment of user pay police for the road closures.
- (D) The Applicant must notify the Transport Management Centre prior to commencement of work.
- (E) The Applicant must provide a telephone number of the supervisor responsible for the proposed closure and include contact details in the notification letters to be distributed to affected stakeholders.

VOTING MEMBERS FOR THIS ITEM

<i>Voting Members</i>	<i>Support</i>	<i>Object</i>
City of Sydney		
Roads and Maritime Services		
NSW Police – Surry Hills LAC		
Representative for the Member for Sydney		

DECISION

BACKGROUND

Adams Traffic Management Pty Ltd has applied for the temporary road closure of Seymour Place, between South Dowling and Selwyn Streets, Paddington, on 25 January, 22 February, 22 March, 19 April, 17 May, 14 June, 12 July, 9 August, 6 September, 4 October, 1 November, 29 November and 27 December 2018, from 10am to 1pm.

COMMENTS

The proposed temporary road closures are required to allow a mobile crane to maintain and/or replace an existing advertising sign at 378 South Dowling Street, Paddington.

Similar temporary closures have occurred in proceeding years without any traffic-related concerns being raised.

The Applicant has provided a site-specific Traffic Control Plan that includes details of barricades, signs, flagmen and other traffic devices to implement the proposed road closures.

There are currently no other approved temporary road closures proposed to take place on the same day in close proximity of this closure.

The temporary road closures will not affect any other properties, as local access will be provided at all times and alternative access routes are available nearby.

A Traffic Management Plan (TMP) for the temporary road closure was approved by Roads and Maritime Services (RMS) on 1 December 2017.

CONSULTATION

The Applicant will be required to notify affected stakeholders as stipulated in Schedule B.

FINANCIAL

All costs associated with the proposed closures will be borne by the Applicant.

Mobile Cranes – Temporary Road Closures – Seymour Place, Paddington

Claudia Calabro, Traffic Works Coordinator

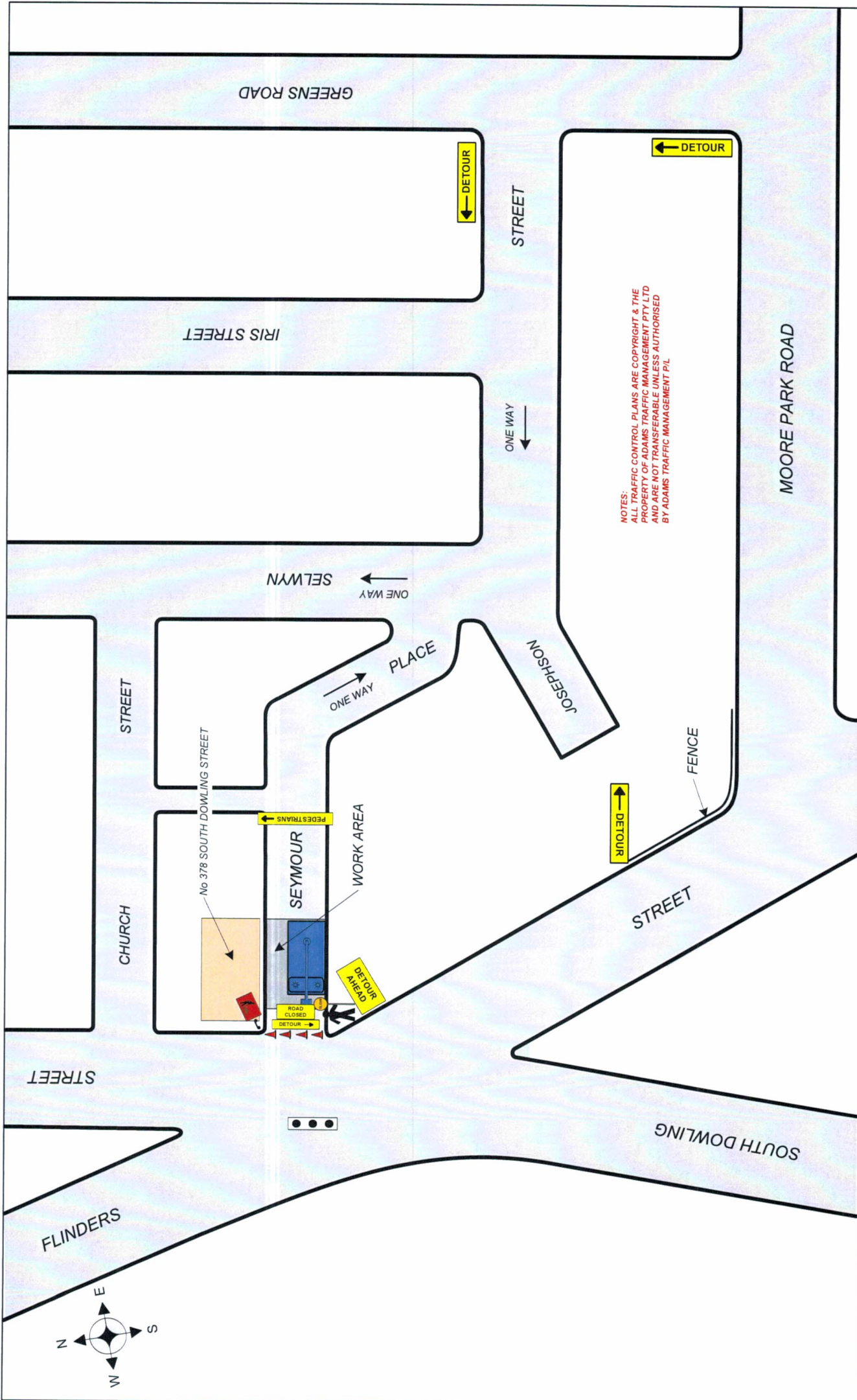

	Email: david@adamstraffic.com.au Email: kerrye@adamstraffic.com.au David 0415 475 742 Fax: 9899 3304 Kerrye 0415 925 861 0402 420 764 Ph.: 1800 330 378 Website: adamstraffic.com.au	Client: Ultimate Signs Location: Seymour Place Paddington	Approach Speeds = up to 60KM Day/Night - Class 1 Signs to be used All Personnel to wear Hi Vis Clothing, Cone Spacing 5M in Taper Cone Spacing 10M in Delineation Vehicles to park within the worksite RMS certified Traffic Controllers to be employed	Drawn by: John Bradford RMS No: 004542706 Exp Date: 20/09/2020 Signed by: _____ Date: 4/10/17	NOT TO SCALE UBD Ref: 195 H1 TCP No: 195
--	---	---	---	---	---

